

## HUMIDITY SEPARATORS

### S16S

### PN 16 and PN 40

#### DESCRIPTION

The S16 series centrifugal separators remove moisture from steam and compressed air pipelines. Steam and compressed air pass through the separator and, as a result of centrifugal forces, impacts and swirling effects, the particles with a heavier specific gravity, such as water and oil droplets, moisture in suspension, dirt and scale are separated from the fluid.

The condensate collected at the bottom of the separator must be automatically drained by a suitable steam or compressed air trap.

#### MAIN FEATURES

Several possibilities of installation.

No moving parts.

Maintenance-free design.

OPTIONS: Flanged condensate connection.

USE: Steam, compressed air and other gases.

#### AVAILABLE

MODELS: S16S – carbon steel.

SIZES: 1/2" to 2".

CONNECTIONS: Female threaded ISO 7 Rp or NPT.

INSTALLATION: Always with the condensate discharge pointing downwards.

See IMI – Installation and maintenance instructions.



#### CE MARKING – GROUP 2 (PED – European Directive)

PN 16	Category	PN 40	Category
1/2" to 1"	SEP	1/2" to 1 1/4"	1 (CE marked)
1 1/4" to 2"	1 (CE marked)	1 1/2" to 2"	2 (CE marked)

#### BODY LIMITING CONDITIONS \*

PN 16		PN 40	
ALLOWABLE PRESSURE	RELATED TEMPERATURE	ALLOWABLE PRESSURE	RELATED TEMPERATURE
16 bar	50 °C	40 bar	50 °C
14,8 bar	100 °C	37,1 bar	100 °C
13,3 bar **	200 °C	33,3 bar **	200 °C
12,1 bar	250 °C	30,4 bar	250 °C

\* Rating according to EN 1092-1:2018.

\*\* PMO – Max. operating pressure for saturated steam.

Minimum operating temperature: -10 °C.

Design code: AD-Merkblatt.

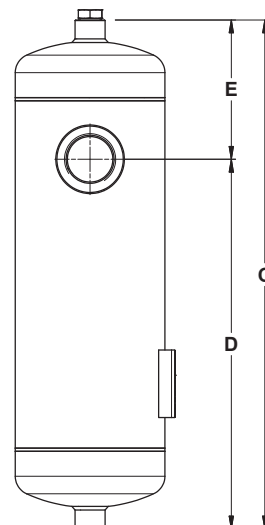
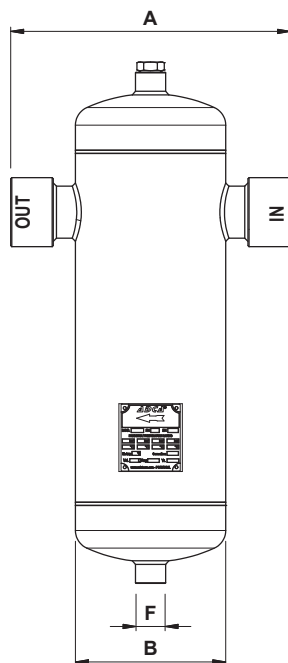

#### DIMENSIONS (mm)

PN 16									PN 40				
SIZE	A	B	C	D	E	F	VOLUME (L)	WEIGHT (kg)	C	D	E	VOLUME (L)	WEIGHT (kg)
1/2"	210	114	300	205	95	1/2"	2	3,7	315	210	105	2,2	5,2
3/4"	210	114	300	205	95	1/2"	2,5	3,9	315	210	105	2,2	5,4
1"	210	114	340	220	120	1/2"	3	4,6	340	220	120	2,4	6
1 1/4"	245	141	435	305	130	1/2"	5	8,2	435	305	130	4,8	11,3
1 1/2"	260	141	475	345	130	1/2"	5,7	9,3	475	340	135	5,4	12,7
2"	300	168	545	405	140	1/2"	10,5	13,6	545	395	150	9,2	19,6

\* As standard, in separators manufactured with ISO 7 Rp threads, the drain connection is also female threaded ISO 7 Rp. In versions with NPT threads, this connection is also female threaded NPT. Alternatively, EN 1092-1 or ASME B16.5 flanged drain connection can be supplied (ASME in the same class as main connections).

Remarks: The top of the separator is supplied with a threaded connection which size does not exceed the size of the drain connection. This connection is always supplied with a threaded socket. It can be used for air venting or sensing pipe connection.

#### MATERIALS

DESIGNATION	MATERIAL
Body	P235GH / 1.0325
Heads	P265GH / 1.0425
Inlet / outlet pipes	P235GH / 1.0325
Inlet / outlet sockets	ASTM A105 / 1.0432
Sockets	ASTM A105 / 1.0432
Internals	S235JR / 1.0038