

HUMIDITY SEPARATORS

S16SS

PN 16 and PN 40

DESCRIPTION

The S16 series centrifugal separators remove moisture from steam and compressed air pipelines. Steam and compressed air pass through the separator and, as a result of centrifugal forces, impacts and swirling effects, the particles with a heavier specific gravity, such as water and oil droplets, moisture in suspension, dirt and scale are separated from the fluid.

The condensate collected at the bottom of the separator must be automatically drained by a suitable steam or compressed air trap.

MAIN FEATURES

Several possibilities of installation.

No moving parts.

Maintenance-free design.

OPTIONS: Flanged condensate connection.

USE: Steam, compressed air and other gases.

AVAILABLE MODELS: S16SS – stainless steel.

SIZES: 1/2" to 2".

CONNECTIONS: Female threaded ISO 7 Rp or NPT.

INSTALLATION: Always with the condensate discharge pointing downwards.
See IMI – Installation and maintenance instructions.



CE MARKING – GROUP 2 (PED – European Directive)

PN 16	Category	PN 40	Category
1/2" to 1"	SEP	1/2" to 1 1/4"	1 (CE marked)
1 1/4" to 2"	1 (CE marked)	1 1/2" to 2"	2 (CE marked)

BODY LIMITING CONDITIONS *

PN 16		PN 40	
ALLOWABLE PRESSURE	RELATED TEMPERATURE	ALLOWABLE PRESSURE	RELATED TEMPERATURE
16 bar	50 °C	40 bar	50 °C
15,1 bar	100 °C	37,9 bar	100 °C
12,7 bar **	200 °C	31,8 bar **	200 °C
11,9 bar	250 °C	29,9 bar	250 °C

* Rating according to EN 1092-1:2018.

** PMO – Max. operating pressure for saturated steam.

Minimum operating temperature: -10 °C.

Design code: AD-Merkblatt.

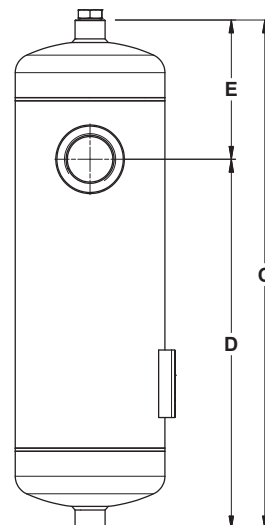
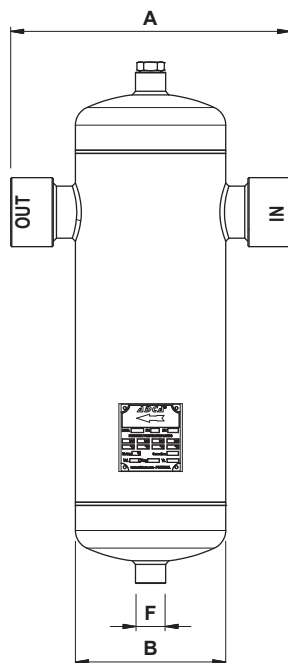

DIMENSIONS (mm)

PN 16									PN 40				
SIZE	A	B	C	D	E	F	VOLUME (L)	WEIGHT (kg)	C	D	E	VOLUME (L)	WEIGHT (kg)
1/2"	210	114	300	205	95	1/2"	2	3,2	300	205	95	2,1	4,5
3/4"	210	114	300	205	95	1/2"	2,3	3,4	300	205	95	2,2	4,6
1"	210	114	340	220	120	1/2"	2,7	4	340	220	120	2,5	5,4
1 1/4"	245	141	435	305	130	1/2"	5,5	7	435	295	140	4,8	11,8
1 1/2"	260	141	475	340	135	1/2"	6,1	8	475	330	145	5,7	13,2
2"	300	168	545	405	140	1/2"	10,9	10,9	545	400	145	9,2	18,8

* As standard, in separators manufactured with ISO 7 Rp threads, the drain connection is also female threaded ISO 7 Rp. In versions with NPT threads, this connection is also female threaded NPT. Alternatively, EN 1092-1 or ASME B16.5 flanged drain connection can be supplied (ASME in the same class as main connections).

Remarks: The top of the separator is supplied with a threaded connection which size does not exceed the size of the drain connection. This connection is always supplied with a threaded socket. It can be used for air venting or sensing pipe connection.

MATERIALS

DESIGNATION	MATERIAL
Body	AISI 316L / 1.4404
Heads	AISI 316L / 1.4404; AISI 316Ti / 1.4571
Inlet / outlet pipes	AISI 316L / 1.4404
Inlet / outlet sockets	AISI 316L / 1.4404
Sockets	AISI 316L / 1.4404
Internals	AISI 316L / 1.4404